

PLANT LIST						
Code	Drought	Qty.	Botanical Name / Common Name	Specifications	Caliper	Total (In Inches)
PROPOSED TREES / PALMS						
AAS	V	9	Archontophoenix alexandreae / Alexander Palm	22" OA Ht., 3" DBH, Single Trunks	3	27
AA12		4	Archontophoenix alexandreae / Alexander Palm	12" OA Ht., 3" DBH, Single Trunks	3	12
AAT		2	Archontophoenix alexandreae / Alexander Palm	12" OA Ht., 3" DBH, Triple Trunks	9	18
BS	(N)	2	Bursaria sinuata / Gumbo Limbo	16" x 6-7, 3" DBH	3	6
CE	(N)	4	Conocarpus erectus sericeus / Silver Buttonwood	10" x 4-5, 1.5" DBH	1.5	6
LB	(N)	5	Lysiloma bahamensis / Wild Tamarind	16" x 6-7, 3" DBH	3	15
LI	V	5	Lagerstroemia muskoguee / Crape Myrtle	10" x 4-5, 2" DBH, Multi 4 Trunks Min.	8	40
LL	V	7	Ligustrum lucidum / Ligustrum Tree	10" x 4-5, 2" DBH, Multi 4 Trunks Min.	8	56
MC	(N)	2	Myrica cerifera / Wax Myrtle	10" x 4-5, 2" DBH, Multi 4 Trunks Min.	8	16
MF	(N)	3	Myrcianthes fragrans / Simpson Stopper	10" x 4-5, 1.5" DBH	1.5	4.5
QV	(N)	5	Quercus virginiana / Live Oak	16" x 6-7, 3" DBH	3	15
		39	Total Trees / Palms (AAS Counted 3:1)			215.5
		21	Native Trees / Palms			152.0
		53%	Native Trees / Palms			0
ACCENTS / SHRUBS / HEDGES						
CIR	(N)	155	Chrysobalanus icaco / 'Red Tip' Coccolupum	24" Ht. x 24" Spr., 24" OC		
CMF	V	3	Caryota mitis / Fishtail Palm	6-7" OA Ht.		
CRS	(N)	112	Clusia rosea / Small Leaf Clusia	24" Ht. x 24" Spr., 24" OC		
DCC	V	5	Dyopsis cabadae / Cabada Palm	7-8" OA Ht., 2" DBH, 6 Canes Min.		
HAS	V	2	Hibiscus standard / Anderson Crape	5-6" x 5-6"		
HIB	V	75	Hibiscus rosa-sinensis / eminoe Pink	24" Ht. x 18" Spr., 24" OC		
LSQ	V	1	Lagerstroemia speciosa / Queen's Crape Myrtle	8-9" x 4-5, 1-1.5" DBH		
PMC	V	14	Podocarpus macrophyllus / Podocarpus Columns	5" Ht., F1B Columns		
REL	V	2	Rhipis excelsa / Lady Palm	4-4.5" OA Ht.		
RNT	V	10	Ravenala madagascariensis / Travelers Tree	9-10" OA Ht.		
SAG	V	37	Schefflera arboricola / Green Dwarf Schefflera	24" Ht. x 18" Spr., 24" OC		
TDF	(N)	23	Tripsacum dactyloides / Fakahatchee Grass	36" Ht. x 36" Spr., 42-48" OC		
TRF	(N)	4	Thrinax radiata / Florida Thatch Palm	Single Trunks, 7-8" OA Ht.		
		443	Total Shrubs			
		294	Native Shrubs			
		66%	Native Shrubs			
GROUND COVERS / SOD						
ANN	L	100	Annual Color / Seasonal Flowers	4" Pot		
BRO	V	45	Bromelad spp. / Mixed Colors	12" Ht., 12" OC		
FMG	V	93	Ficus microcarpa / Green Island Ficus	24" Spr., 24" OC		
LME	V	65	Liriope muscari 'eg' / Liriope Evergreen Giant	12" Ht., 12" OC		
SOD	M		S.F. Stenotaphrum secundatum / St. Augustine 'Palmetto'	Solid application - no gaps between seams		
Z-SOD	M		S.F. Zoysia spp. / Empire Zoysia	Solid application - no gaps between seams		
	(N)		Florida Native Plant Species			
	V		Very Drought Tolerant			
	M		Medium Drought Tolerant			
	L		Low Drought Tolerant			

CITY OF POMPANO BEACH PLANTING CALCULATIONS				
LANDSCAPE QUANTITY REQUIREMENTS				
Plot Tree Requirement: One Tree for every 3,000 square feet 21,340 Square Feet of Lot Area. (Min. 50% shall be installed relating to the ht. of the main structure. = 14')	Required	8	Provided	8
Plot Shrub Requirement: 5 Shrubs per Tree		40	194	
Perimeter Tree Requirement: One Per 30' of Perimeter Linear Feet 293 Feet Total Perimeter 150 Linear Feet North Property Line 143 Linear Feet West Property Line	Required	10 5 5	Provided 10 5 5	
Continuous hedge			Contd. Hedge	
155.5203.G.2.c	Street Tree Requirement: One Per 40' of Street Frontage. 10'x6', 2" DBH. 100 Feet of SW 7th Street Frontage 119 Feet of Hibiscus Avenue Street Frontage (Minus 24' Driveways)	Required 3 3	Provided 3 3	
	20% Native Tree Requirement When 20 or more trees are required. Total Trees / Palms Total Native or Drought Tolerant Trees / Palms % Native or Drought Tolerant Trees / Palms		Provided 20 20 100%	
155.5203.D.4	15% Interior landscape = to 15% of the total VUA 3360 Total VUA	Total 24	24	15%

CITY OF POMPANO BEACH				
SITE PLAN INFORMATION				
Land Use Designation: Multi Family Residential				
Zoning Designation: RM-20				
Net Site Area:	21,340 Sq. Feet	=	0.49	Acres
Building Area:	8,296 Sq. Feet	=	38.9%	
VUA Areas:	3,910 Sq. Feet	=	18.3%	
Pool, Pool Deck	2,673 Sq. Feet	=	12.5%	
Misc Conc. Walks, Pads	1,050 Sq. Feet	=	4.9%	
Total Impervious Areas:	15,929 Sq. Feet	=	74.6%	
Landscape Area:	5,411 Sq. Feet	=	25.4%	
Total Pervious Areas:	5,411 Sq. Feet			

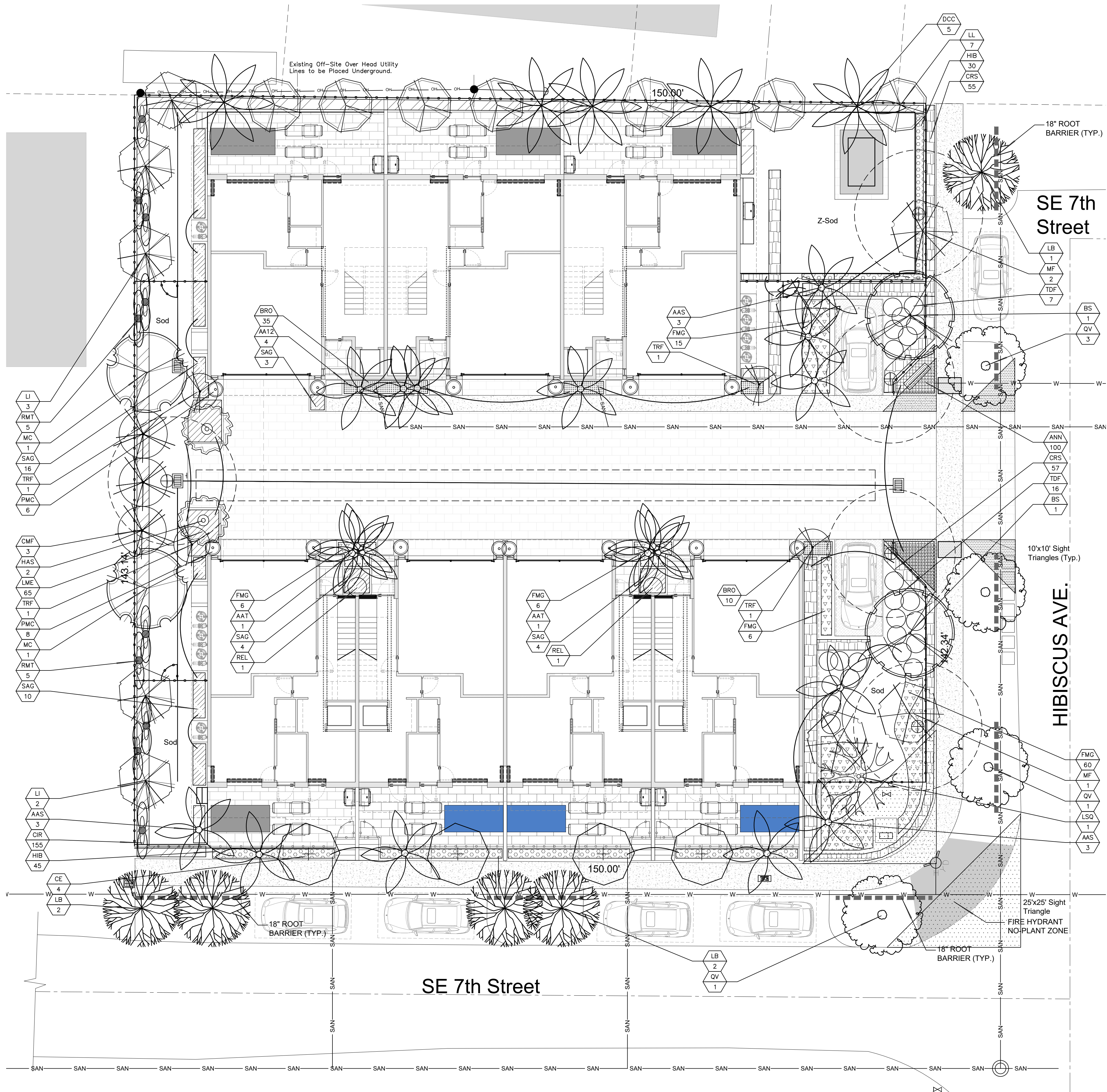

THOMAS WHITE, ASLA-ISA  
LANDSCAPE ARCHITECT, LEED GREEN  
ASSOCIATE, CERTIFIED ARBORIST  
2600 NE 27th AVENUE  
FORT LAUDERDALE, FLORIDA 33306  
tcwhite@telsouth.net  
954-253-2265

#### REVISIONS

1-24-2023: Site Plan  
Modifications  
3-14-2023: Per City  
Comments  
3-29-2023: Site Plan  
Modifications

## Hibiscus Park Townhomes

3213 SE 7th Street  
Pompano Beach, FL 33062



DRAWN:  
TW  
CHECKED:  
TW  
DATE:  
12-10-2022  
SCALE: 1"=10'

Sheet No.  
L-1.2  
Sheet 2 Of 3